

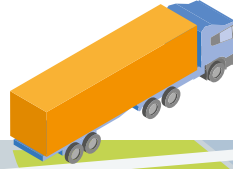

HOLCIM CIRCULATION PLAN

3 FLUFF



Walking floor



3 Fluff



First aid



Emergency shower



Assembly Point



Pedestrians authorised track

3 FLUFF F10



In case of emergency
0032 (0)65 358 333

A IN + AREA 'WEIGHING BRIDGE' + AREA 'SAMPLING BRIDGE'

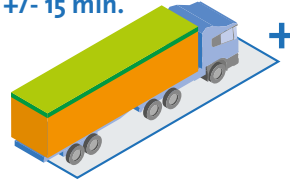

- Acceptation certificate
- Safety1 certificate
- CMR
- Transport document

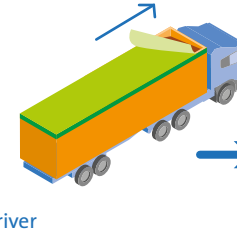
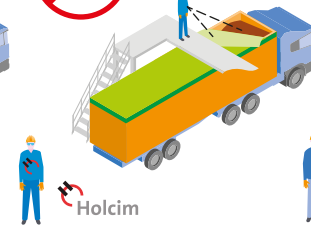
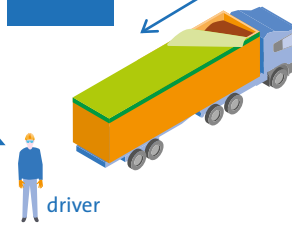
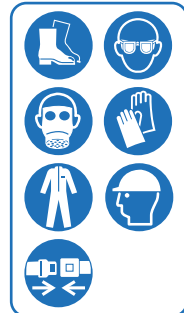

AREA **3**
'Fluff F10'

B AREA '3 FLUFF F10'

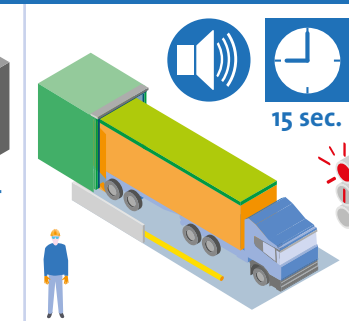
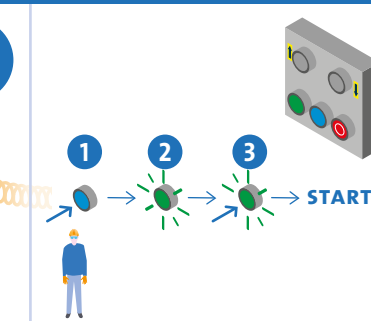
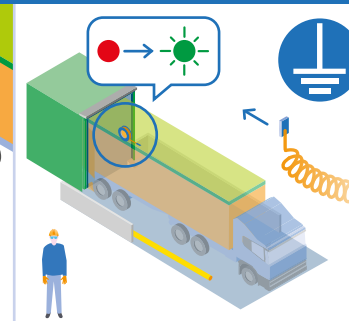
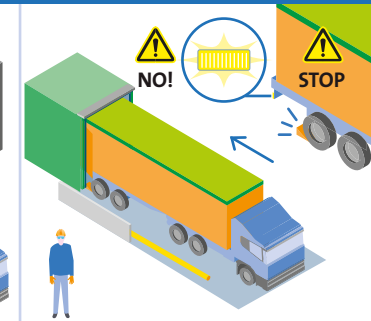
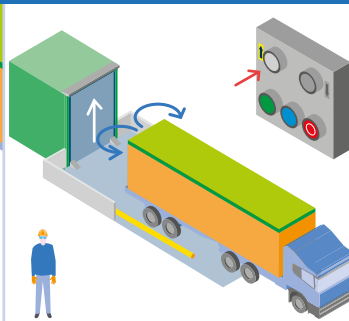
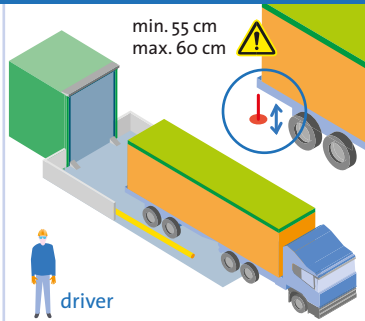

B (CONTINUED)

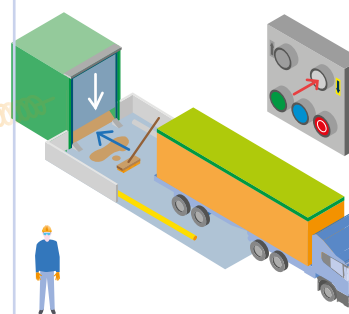
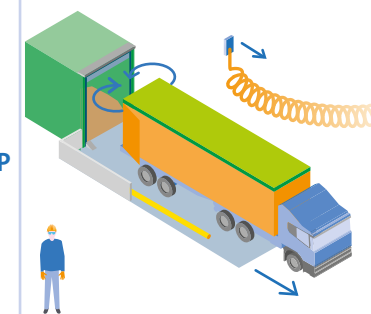
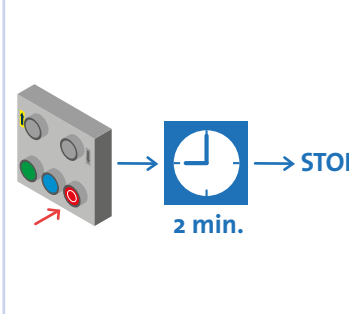
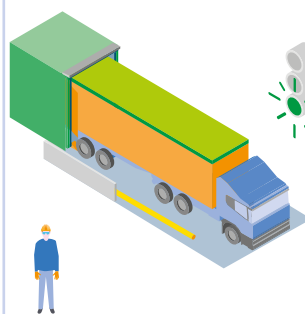

C AREA 'WEIGHING BRIDGE' + EXIT

